

**ACOUSTIC DOOR****60 minute fire rated 30 Rw single leaf acoustic / smoke / fire door****DESCRIPTION**

Pyropanel AS-30-PAN-E is a 30 Rw, 1 hour fire rated 48mm nominal single leaf acoustic door that utilises a Pyropanel Euroseal concealed perimeter seal and an approved bottom seal.

**APPLICATIONS**

Ideal for unit entry applications or anywhere that requires 60 minutes of fire resistance and an acoustic rating of 30 Rw.

**FEATURES****Acoustic Rating**

- 30 Rw

**Fire Resistance**

- FRL -/60/30

**Smoke Resistance**

- Meets the NCC requirement for a smoke door.

**Door Configuration**

- Single leaf hung in a steel or timber frame.

**Perimeter Seals**

- Pyropanel Euroseal® concealed smoke/acoustic seal

**Bottom Seals**

- See seal combinations listed on page 2.

**Thickness**

- 48mm (Nominal)

**Size**

- Maximum Size - 2420 x 1020 or 2200 x 1120 (-/60/30)

**Hinges**

- Minimum 3 steel hinges.

**Frame**

- Pyropanel KDHW timber or packed steel frame.

**Finish**

- MDF as standard.

**OPTIONAL EXTRAS**

- Pre-hung in steel or timber frame
- Ply, Veneer, Steel or Laminate facings
- Vision panels—300 x 200 or 600 x 100mm.
- Kick Panels of 1mm Stainless Steel to selected height.

**INSTALLATION**

Door frame must be tightly sealed against wall structure using Pyropanel Multiflex fire and acoustic sealant. Steel door frames will require packing with Pyropanel FR board, Fire rated plaster, concrete or mortar to achieve desired acoustic rating.

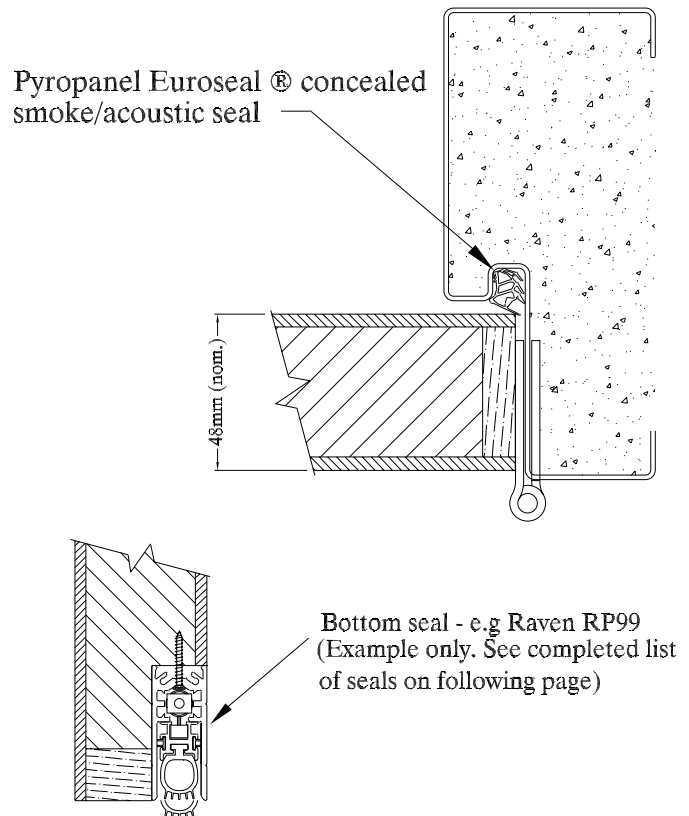
**HOW TO SPECIFY**

"Door to be a Pyropanel AS-30-PAN-E acoustic door with -/60/30\* FRL, installed into a Pyropanel Fire rated timber / packed steel\* door frame, with Pyropanel Euroseal and Raven RP99si\* seals"

\* denotes example - delete, change or specify as required

**Pyropanel Developments Pty Ltd**

Unit 1, 97 Lewis Rd, Wantirna South, Vic 3152

Ph: **(03) 9837 8500** Fax: (03) 9837 8550

Email: **sales@pyropanel.com.au**

Web: **www.pyropanel.com.au**

**Distributed by:**

60 minute fire rated 30 Rw single leaf acoustic / smoke / fire door

**SEAL COMBINATIONS**

Door Type	Perimeter Seals	Bottom Seals
AS-30-PAN-E	Pyropanel Euroseal	Raven RP99si
		Raven RP38si
		Raven RP35si
		Raven RP8si
		Lorient LAS8001si
		Lorient LAS8002si
		Lorient LAS8003si
		Lorient LAS8005si
		Lorient LAS8006si
		Lorient LAS8007si
		Lorient LAS8008si
		Lorient LAS8009si

**Pyropanel Developments Pty Ltd**

Unit 1, 97 Lewis Rd, Wantirna South, Vic 3152

Ph: **(03) 9837 8500** Fax: (03) 9837 8550Email: **sales@pyropanel.com.au**Web: **www.pyropanel.com.au****Distributed by:**