

ACOUSTIC DOOR

AS-40-FRB

TECH SHEET—AS-40-FRB

Issue: 13-12-04

**2 hr fire rated 40 Rw single acoustic /
smoke / fire door**

DESCRIPTION

Pyropanel AS-40-FRB is a 40 Rw, 2 hour fire rated 50mm single leaf acoustic door that utilises a Raven RP39 perimeter smoke / acoustic seal and a Pyropanel 'Pyrosill' bottom seal. This door comes standard with ply faces.

APPLICATIONS

Ideal for applications that requires up to 2 hours of fire resistance and an acoustic rating of 40 Rw, such as warehouses and factories.

FEATURES

Acoustic Rating

- 40 Rw (40 STC)

Test Certificate number

- T423/Spec 4

Fire Resistance

- -/120/30

Door Configuration

- Single leaf hung in a steel frame

Perimeter Seal

- Raven RP39 magnetic smoke / acoustic seal

Bottom Seal

- Pyropanel 'Pyrosill' sill seal

Thickness

- 50mm (Nominal)

Size

- Maximum Size - 2400 x 1020

Hinges

- Minimum 3 steel hinges

Frame

- Packed pressed metal frame (2 hr)

Finish

- Ply to both faces

OPTIONAL EXTRAS

- Pre-hung in steel frame
- Ply, MDF, Veneer or Laminate facings can be applied over existing face
- Stainless steel faces
- Vision panels - 300 x 200 or 250 x 250mm.
- Kick Panels of 1.2mm Stainless Steel to selected height
- Meets the BCA requirement for a smoke door.

INSTALLATION

Door frame must be tightly sealed against wall structure using Pyropanel Multiflex or approved alternative fire and acoustic sealant. Metal door frames will require packing with Pyropanel FR board, Fire rated plaster, concrete or mortar to achieve desired acoustic and fire rating.

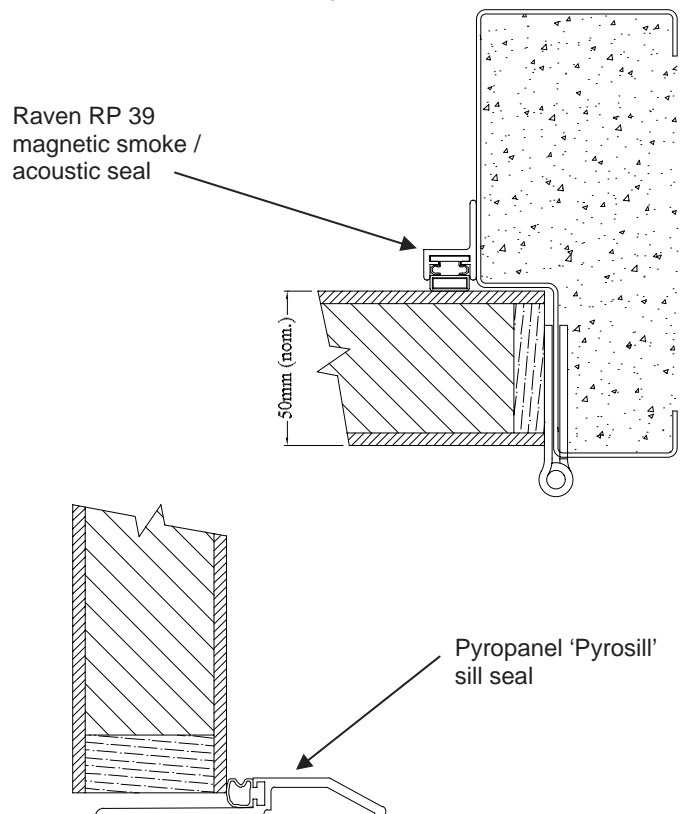

HOW TO SPECIFY

"Door to be a Pyropanel AS-40-FRB acoustic door with -/120/30 FRL and installed in a packed pressed metal door frame*"*

* denotes example—delete, change or specify as required



Pyropanel Developments Pty Ltd
122-124 Beresford Rd, Lilydale, VIC, 3140
Ph: (03) 9735 5688 Fax: (03) 9739 5772
Email: sales@pyropanel.com.au
Web: www.pyropanel.com.au

Distributed by: