

ACOUSTIC DOOR

AS-27-PAN-E

TECH SHEET—AS-27-PAN-E

Issue: 13-12-04

**1 Hr fire rated 27 Rw single acoustic /
smoke / fire door**

DESCRIPTION

Pyropanel AS-27-PAN-E is a 27 Rw 1 hour fire rated 38mm single leaf acoustic door that utilises a Raven Products bottom seal and a Pyropanel Euroseal concealed perimeter seal. This door has also been tested to AS 1530.7 for smoke leakage.

APPLICATIONS

Ideal for unit entry applications or anywhere that requires 1 hour of fire resistance and an acoustic rating of 27 Rw.

FEATURES

Acoustic Rating

- 27 Rw (27 STC)

Test Certificate number

- TL373(a)

Fire Resistance

- FRL -/60/30

Door Configuration

- Single leaf hung in a steel or timber frame.

Perimeter Seal

- Pyropanel Euroseal® concealed smoke/acoustic seal

Bottom Seal

- Raven RP99

Thickness

- 38mm (Nominal)

Size

- Maximum Size - 2200x920 (-/60/30)
- 2200x1020 (-/30/30)
- 2400x1100 (- / - / -)

Hinges

- Minimum 3 steel hinges

Frame

- Pyropanel KDHW timber or packed pressed metal frame

Finish

- MDF as standard

OPTIONAL EXTRAS

- Pre-hung in steel or timber frame
- Ply, Veneer, Steel or Laminate facings
- Vision panels—300 x 200 or 250 x 250mm.
- Kick Panels of 1.2mm Stainless Steel to selected height
- Tested for smoke leakage - refer Pyropanel Life Safety door model LSD-60-C/MS/EU for smoke leakage data

INSTALLATION

Door frame must be tightly sealed against wall structure using Pyropanel Multiflex or approved alternative fire and acoustic sealant. Metal door frames will require packing with Pyropanel FR board, Fire rated plaster, concrete or mortar to achieve desired acoustic rating.

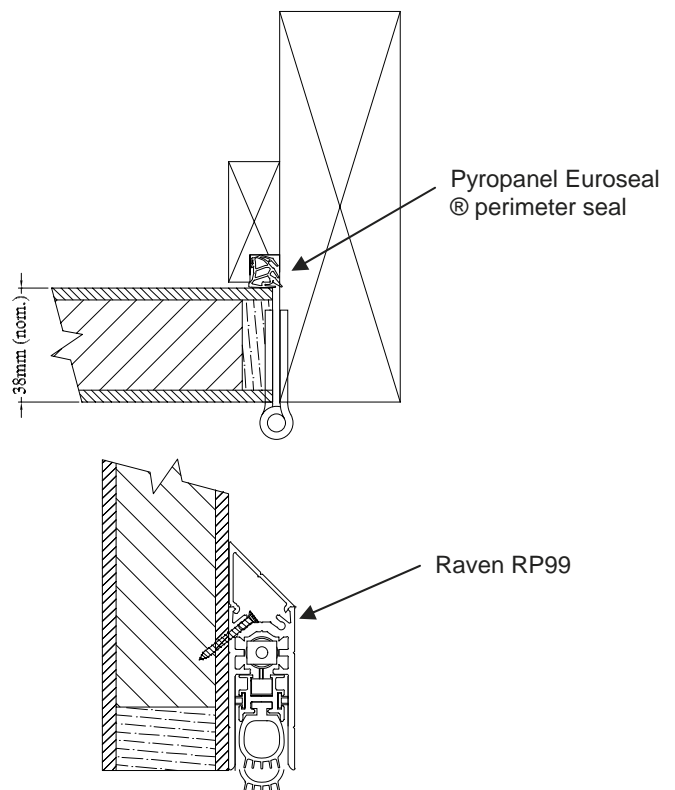

HOW TO SPECIFY

"Door to be a Pyropanel AS-27-PAN-E acoustic door with -/60/30 FRL, installed into a Pyropanel Fire rated timber / packed metal* door frame"*

* denotes example—delete, change or specify as required



Pyropanel Developments Pty Ltd
122-124 Beresford Rd, Lilydale, VIC, 3140
Ph: (03) 9735 5688 Fax: (03) 9739 5772
Email: sales@pyropanel.com.au
Web: www.pyropanel.com.au

Distributed by: