

DESCRIPTION

Fire doors must be installed to AS1905.1 or as per tested or assessed, which includes the allowable gaps around the stiles, head and base of the door. The following technical sheet describes the maximum allowable gaps and acceptable rectification methods.

ACCEPTABLE CLEARANCES

- **Stiles and head:**
 - In the closed position, gaps between the door and frame jamb (head, hinge and lock stiles) are not to exceed 3mm.
 - Door leaf to the door seat rebate to not exceed 5mm average.
- **Bottom:**
 - Maximum allowable gap between leaf and top of finished floor level is 10mm (3-10mm is recommended)
(Note: Up to 15mm gap is approved on some doors, contact licensed distributor to confirm.)

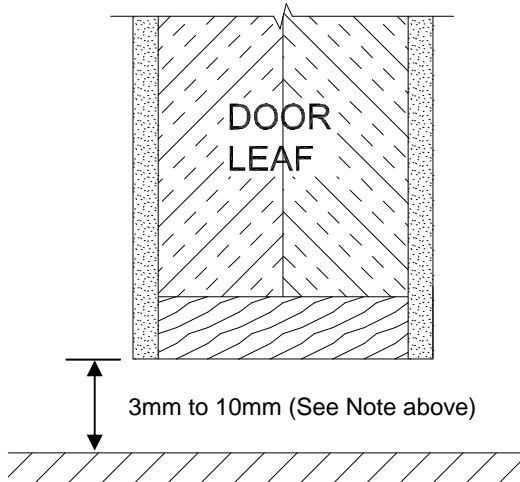

RECTIFICATION OF EXCESS GAPS

Stiles and head:

Gaps between door leaf and frame can be reduced by using the following methods:

- Lorient HP4002 stick on perimeter seal attached to door frame or door leaf

Lorient HP4002:

- Can be used where there are excessive stile or head gaps.
- Can be used on each stile of door leaf
- Integrated self adhesive tape is used to apply seal to door rebate.

HP4002 1.6mm thick X 40mm wide

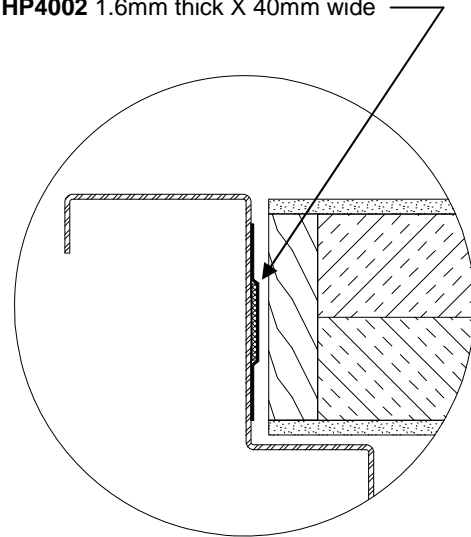

Continued...

RECTIFICATION OF EXCESS GAPS

Bottom:

Gaps of up to 20mm at the bottom of the door can be reduced by using the following methods:

(Note: The following methods are approved up to 2hr fire rating, Contact Pyropanel Distributor for more info)

- **Lorient FDBU20** can be used for up to 20mm gap
- **Raven RP114** can be used for up to 20mm gaps
- **Pyropanel Greenboard** can be used to reduce gaps by 10mm.
- **Non combustible threshold seals** can be used to reduce the gap under a fire door:
 - Raven RP28, RP29, RP77, RP82, RP95 (gaskets must be removed), Lorient IS4070, IS4075, IS4010, IS4015, IS4020, IS4025, IS4110, IS4120

Raven RP114:

Raven RP114 should just clear the floor during door opening and closing. To avoid the seal fouling on uneven or sloping surfaces the finned gasket portion should engage an approved Raven threshold plate

- **Location:** Bottom of Fire and smoke doors.
- **Min/Max Gap:** 14mm to 20mm (without Raven threshold plate)
- **Seal Sizes:** Available 820mm, 915mm, 1220mm.
- **Standard Finish:** Anodised Satin Clear or Bronze.
- **Fixing method:** Simply cut seal to length. Zinc plated cross recess head ST screws of the appropriate size are supplied.
- **Seal Material:** Intumescent infill, S.E. flexible PVC cover strip and finned gasket.
- **Used in conjunction with** approved Raven door frame seals and threshold plates.

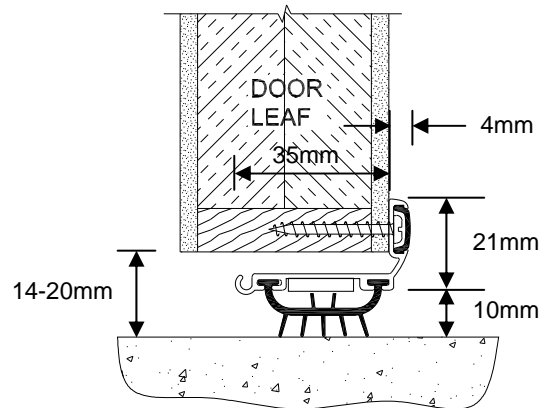

Raven RP114 installed on a 48mm fire door

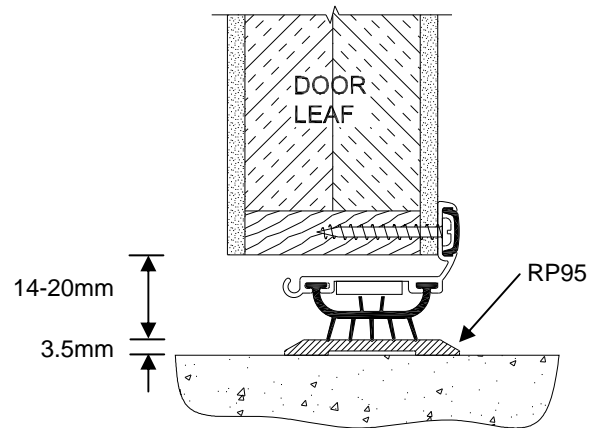

Raven RP114 installed on a 48mm fire door with additional Raven RP95 threshold seal

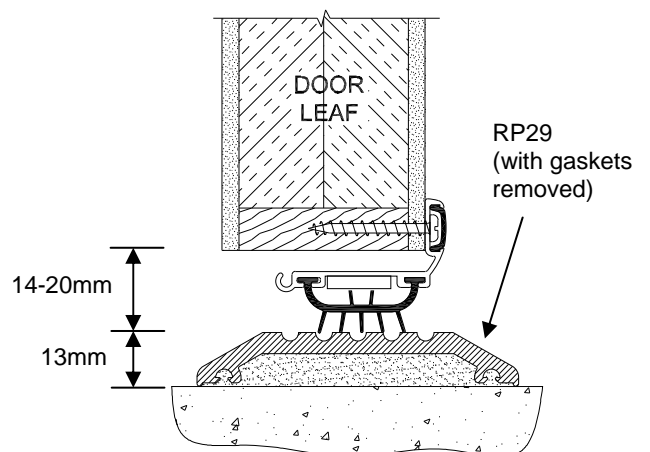

Raven RP114 installed on a 48mm fire door with additional Raven RP29 threshold seal

Continued...

Rectification of bottom gaps con't.

Lorient FDBU20:

Lorient FDBU20 can be used to upgrade existing internal fire doors where door bottom gaps exceed the allowable 10mm as per AS/NZS1905.1. It is constructed from anodised aluminium profile, and incorporates a flame retardant smoke, draught and light excluding gasket, and integral high performance intumescent fire seal.

- **Location:** Bottom of Fire and smoke doors.
- **Min/Max Gap:** 14mm to 20mm
- **Seal Sizes:** 820mm, 915mm, 1220mm.
- **Standard Finish:** Anodised aluminium.
- **Fixing method:** cut seal to length and attached with screws
- **Used in conjunction with** approved Lorient door frame seals and threshold plates.

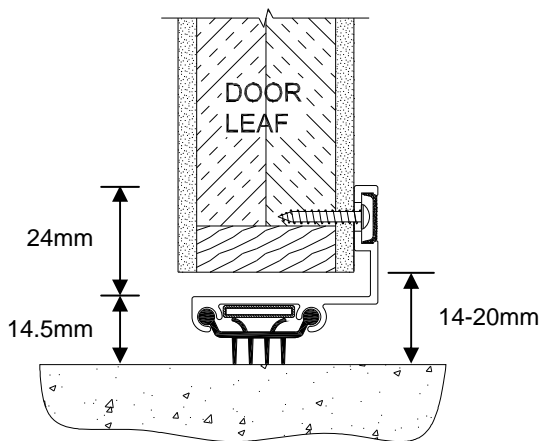

Lorient FDBU20 installed on a 38mm fire door

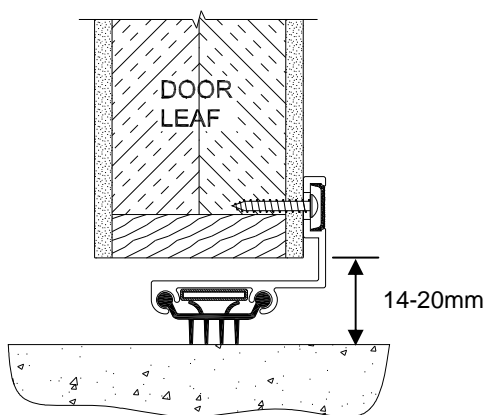

Lorient FDBU20 installed on a 48mm fire door

MODEL NUMBERS

Raven Seals

| Seal | Product Code | Finish | Length (mm) |
|-------|--------------|-----------------|-------------|
| RP114 | OEM114C820 | Clear Anodised | 820 |
| | OEM114B820 | Bronze Anodised | 820 |
| | | | |
| | OEM114C915 | Clear Anodised | 915 |
| | OEM114B915 | Bronze Anodised | 915 |
| | | | |
| | OEM114C1220 | Clear Anodised | 1220 |
| | OEM114B1220 | Bronze Anodised | 1220 |

Lorient Seals

| Seal | Product Code | Door thickness | Std Colour | Length (mm) |
|--------|----------------|----------------|--------------|-------------|
| FDBU20 | FDBU20-820-CA | 35-48 | Silver | 820 |
| | FDBU20-920-CA | 35-48 | Silver | 920 |
| | FDBU20-1220-CA | 35-48 | Silver | 1220 |
| | | | | |
| HP4002 | HP4002-1000 | 35-48 | White, Grey* | 1000 |
| | HP4002-2100 | 35-48 | White, Grey* | 2100 |
| | HP4002-2400 | 35-48 | White, Grey* | 2400 |
| | HP4002-3000 | 35-48 | White, Grey8 | 3000 |

Notes:

HP4002 may be painted over
Other colours available on special order