

# ACOUSTIC DOOR

## AS-PYROL-A

TECH SHEET: AS-PYROL-A

Issue: 02-02-2012

**Non fire rated 36 & 34 Rw single acoustic / smoke door**

### DESCRIPTION

Pyropanel AS-PYROL-A is a non fire rated 48mm single leaf acoustic. This door comes standard with LP-design metal facings and door edges.

### APPLICATIONS

Ideal for applications that require no fire resistance, but require smoke resistance and an acoustic rating of 34 or 36 Rw, such as acoustic smoke doors in hospitals, schools and offices.

### FEATURES

#### Acoustic Rating

- 36 Rw or 34 Rw

#### Test Certificate number

- TL409(m)

#### Door Weight

- Approx 40kg/m<sup>2</sup>

#### Smoke Resistance

- Meets BCA requirement for a smoke door

#### Door Configuration

- Single leaf hung in a timber or steel frame

#### Thickness

- 48mm (Nominal)

#### Size

- Maximum Size - 2500 x 1000 or 2100 x 1200

#### Hinges

- Minimum 3 steel hinges

#### Frame

- Packed pressed metal frame

#### Finish

- Metal facings (LP design)

### OPTIONAL EXTRAS

- Pre-hung in steel frame
- Stainless steel face and edge
- Vision panels - 300 x 200 or 600 x 100mm.

### INSTALLATION

Door frame must be tightly sealed against wall structure using Pyropanel Multiflex or an approved alternative acoustic sealant. Metal door frames will require packing with Pyropanel FR board, plasterboard, concrete or mortar to achieve desired acoustic rating.

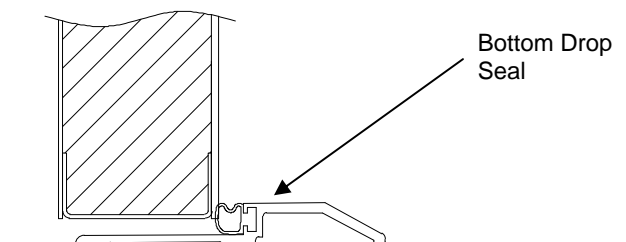
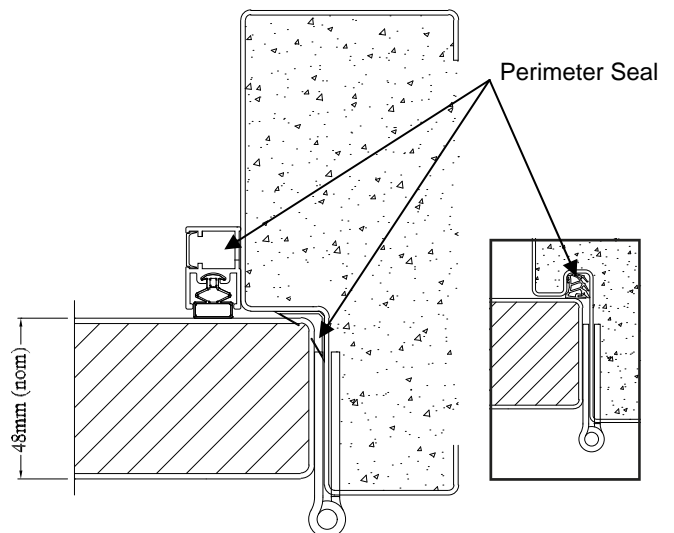

### HOW TO SPECIFY

*"Door to be a Pyropanel AS-PYROL-A1\* acoustic door installed into a timber\* or packed metal door frame\*"*

\* denotes example—delete, change or specify as required

Door Type	Perimeter	Bottom	Rw
AS-PYROL-A1	IS6030 + LE1515	Pyrosill	36
AS-PYROL-A2	Zero 3708A	Pyrosill	36
AS-PYROL-A3	Euroseal	Pyrosill	34



**Pyropanel Developments Pty Ltd**  
 122-124 Beresford Rd, Lilydale, VIC, 3140  
 Ph: (03) 9739 3100 Fax: (03) 9739 3115  
 Email: sales@pyropanel.com.au  
 Web: www.pyropanel.com.au

**Distributed by:**