

# ACOUSTIC DOOR

## AS-30-PAN-E

TECH SHEET: AS-30-PAN-E

Issue: 30-07-2010

**60 minute fire rated 30 Rw single acoustic / smoke / fire door**

### DESCRIPTION

Pyropanel AS-30-PAN-E is a 30 Rw, 1 hour fire rated 48mm single leaf acoustic door that utilises a Raven Products bottom seal and a Pyropanel Euroseal concealed perimeter seal. This door has also been tested to AS 1530.7 for smoke leakage.

### APPLICATIONS

Ideal for unit entry applications or anywhere that requires 60 minutes of fire resistance and an acoustic rating of 30 Rw.

### FEATURES

#### Acoustic Rating

- 30 Rw (30 STC)

#### Test Certificate number

- TL373(n)

#### Fire Resistance

- FRL -/60/30

#### Door Configuration

- Single leaf hung in a steel or timber frame.

#### Perimeter Seal

- Pyropanel Euroseal® concealed smoke/acoustic seal

#### Bottom Seal

- Raven RP99

#### Thickness

- 48mm (Nominal)

#### Size

- Maximum Size - 2420 x 1020 or 2200 x 1120 (-/60/30)

#### Hinges

- Minimum 3 steel hinges

#### Frame

- Pyropanel KDHW timber or packed pressed metal frame

#### Finish

- MDF as standard

### OPTIONAL EXTRAS

- Pre-hung in steel or timber frame
- Ply, Veneer, Steel or Laminate facings
- Vision panels - 300 x 200 or 600 x 100mm.
- Kick Panels of 1.2mm Stainless Steel to selected height
- Tested for smoke leakage - refer Pyropanel Life Safety door model LSD-C/MS/EU for smoke leakage data.

### INSTALLATION

Door frame must be tightly sealed against wall structure using Pyropanel Multiflex or approved alternative fire and acoustic sealant. Metal door frames will require packing with Pyropanel FR board, Fire rated plaster, concrete or mortar to achieve desired acoustic rating.

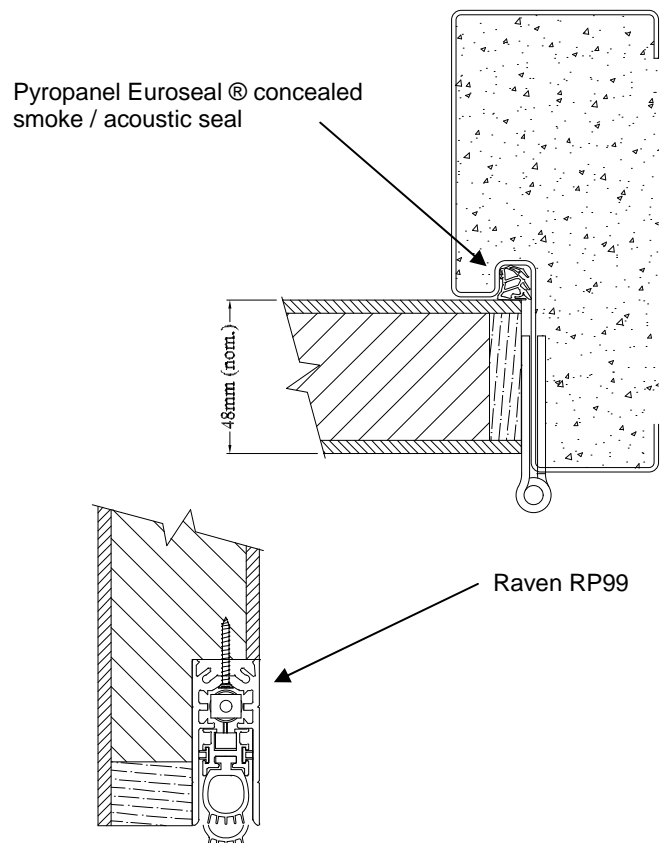

### HOW TO SPECIFY

*"Door to be a Pyropanel AS-30-PAN-E acoustic door with -/60/30\* FRL, installed into a Pyropanel Fire rated timber / packed metal\* door frame"*

\* denotes example—delete, change or specify as required

**PYROANEL**

Protecting Life and Property

Pyropanel Developments Pty Ltd  
122-124 Beresford Rd, Lilydale, VIC, 3140  
Ph: (03) 9739 3100 Fax: (03) 9739 3115  
Email: sales@pyropanel.com.au  
Web: www.pyropanel.com.au

Distributed by: